

# the catawba

2 Story/4-5 Bed/3 Bath/Large Bonus Room/Dining or Flexible Room/Covered Rear Patio  
3585 Square Feet



## ABOUT THE CATAWBA

This plan is open, inviting, and flexible, just like the river it is named after. Thoughtfully engineered to give you maximum livability, enjoy expansive gathering areas on both levels. The stunning kitchen boasts a huge island bar, pantry and planning nook. Dining space and flexible rooms can be formal or informal. As you ascend the stairs find an oversized bonus area, dramatic owner's suite with dressing area. And all bedroom offer plenty of storage and style. Don't miss the welcoming front porch, light-on-three sides covered rear patio, and wide drop zone at garage entry. Flexible rooms on both levels keep the promise that the Catawba lives intelligently and stylishly in every way.

Renderings shown are meant to be representative of the home and may include details, features or colors not included in the actual home. Please consult sales representative for details.

Contact: **Paul Stanger**

704.275.9170

pstanger@evanscoghill.com

[evanscoghill.com](http://evanscoghill.com)

NIMS VILLAGE

30 Exceptionally Large Homesites · Natural Wooded Environment · Fort Mill Location · Thoughtfully Designed Homes

# NIMS VILLAGE

## the catawba

4-5 Beds/3.5 - 4.5 Baths/2-Car Garage/Upper Owner's/ Main Guest

3585 - 3800 Square Feet

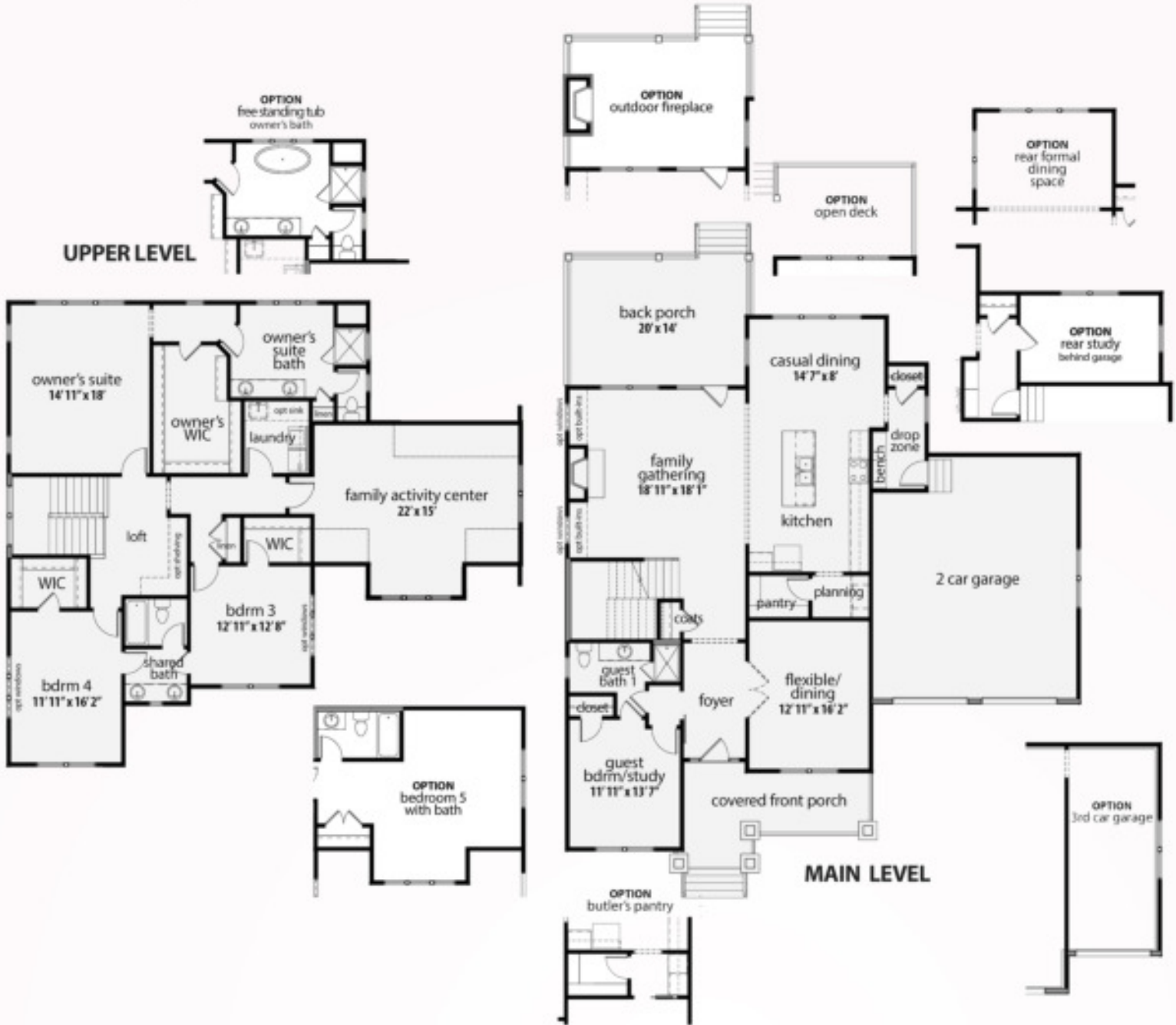

Renderings shown are meant to be representative of the home and may include details, features or colors not included in the actual home. Please consult sales representative for details.

Contact: **Paul Stanger**  
 704.275.9170  
 pstanger@evanscoghill.com